

BUILDING OUR CATHOLIC FUTURE:

CHARITY RAFFLE

OFFICIAL INFORMATION & RULES

The Diocese of Great Falls-Billings is holding the First Annual Family Recreation Raffle. This raffle will be a major fundraiser with the focus on building our Catholic future. We are offering a total of 8 prizes, including 4 early bird cash prizes and 4 other major prizes. All these prizes are geared towards focus on the family and family fun events. Montana is such a beautiful state and God's Big Sky Country is where we love to have fun with family!

Q&A

DID THE DIOCESE USE CARE AND SHARE DOLLARS TO FUND THIS RAFFLE?

No, we were blessed to have a single donor gift us \$50,000 to fund a raffle. All the prizes were purchased with this gift.

HOW WILL THIS RAFFLE BENEFIT OTHER CATHOLIC ENTITIES?

The funds generated from this raffle will benefit Catholic ministries throughout Eastern Montana. By purchasing your raffle tickets from your Catholic parish or a Catholic school, the location selling the tickets will earn \$5 of every ticket sold. As a bonus, the parish or school that sells the highest number of tickets will earn an additional \$1 for each ticket sold.

An additional bonus of \$500 will go to a Catholic parish or school within the Diocese of Great Falls-Billings. The parish or school is chosen by the 4 major gift recipients.

HOW CAN I REQUEST TICKETS?

Call the Chancery office at 406-727-6683 email smurphy@diocesegfb.org

CAN I PURCHASE TICKETS THROUGH THE MAIL?

Yes, go to www.diocesegfb.org On the front page click on the raffle poster and print off the "Ticket Purchase Form" fill out the form, issue your check or money order to Diocese of Great Falls-Billings, send it in and we will mail you your ticket stubs. Please make sure these will reach the Chancery on or before the deadline dates for drawings.

IF I REQUEST 500 TICKETS AND I DISBURSE THEM TO MY STAFF, HOW CAN I KEEP TRACK OF THEM?

Go to the www.diocesegfb.org website and click on the raffle poster and print off the form called "Distribution Form". You can use this to internally track who has which tickets (each ticket is individually numbered).

DATES OF THE RAFFLE

- This charity raffle runs September 5, 2020 through May 15, 2021.
- Early Bird cash drawings take place at the Diocese Chancery November 16, December 16, January 15, and February 16.

TICKETS

- All tickets must be submitted to the Diocese of Great Falls with an accompanying Reconciliation Form.
- Tickets and funds must be verified by 2 individuals and they must sign off on the Reconciliation Form.
- Ticket price is \$20 each.
- All ticket sales are by cash or check only (no credit cards).
- Tickets may be purchased in person or by mail (see "Tickets Purchase Form".)
- No tickets can be purchased electronically over the internet.
- ONLY 60,000 tickets will be printed and sold. The odds of winning any prize are based on the actual number of tickets sold, up to 1:60,000.
- Tickets will be available at the Chancery of the Diocese of Great Falls-Billings, 121 23rd St, South, Great Falls, Montana; Catholic churches and schools within the Diocese of Great Falls-Billings, and at participating sponsor locations.
- Off-site ticket sales will close May 10, 2021, with any remaining tickets will be sold only at the Chancery (121 23rd St. South, Great Falls) through May 15.

PRIZES

Early Bird Cash



Early Bird Cash Prizes will be randomly drawn monthly, November 2020 through February 2021, at the chancery of the Diocese of Great Falls-Billings. Ticket sales and drawing dates are shown below:

<u>Closing</u>	<u>Drawing Date</u>	<u>Amount</u>
November 11, 2020	November 16, 2020	\$500
December 9, 2020	December 16, 2020	\$500
January 11, 2021	January 15, 2021	\$500
February 10, 2021	February 16, 2021	\$500

Major prizes will be randomly drawn on May 15, 2021 in Great Falls at an event to be announced.

MAJOR PRIZES:

GRAND PRIZE (One prize will be awarded)

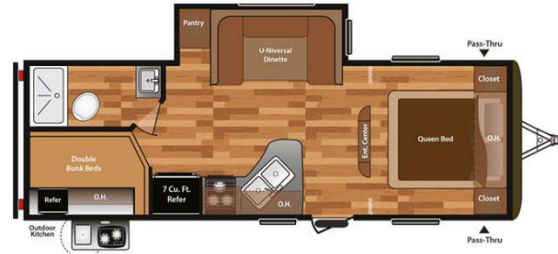

24BHSWE

2021 Keystone HideOut 24BHSWE camper: value \$26,506; or \$15,000 cash (winner's choice). This 24' travel trailer offers a standard kitchen, queen bed and double bunks, slide-out with U-shaped dining area, power jacks and outdoor kitchen. This camper sleeps six and is perfect for family camping.

(Picture is the 2020 model)

SECOND PRIZE (One prize will be awarded)



2021 Honda Pioneer 1000-5 Deluxe, Utility Terrain Vehicle: value \$19,324. This deluxe, red, side-by-side offers a 999cc engine and 2,000 lb. towing capacity. It comes equipped with automatic dual clutch transmission, Quickflip seats, independent rear suspension, AT/MT modes, LED headlights, 14" blacked-out aluminum wheels, and Maxxis Bighorn 2.0 tires. This ATV seats 5 or put down the back seats and haul what you need. See full specifications at

<https://powersports.honda.com/sxs/recutility/pioneer-1000-5>

THIRD PRIZE (Two prizes will be awarded)



OUTDOOR FUN WITH FAMILY is not fun without the Ultimate Montana Barbeque Package, featuring Pro Series 34 Traeger grill including cover with Traeger accessories, 60lbs of pellets, beef rub and BBQ sauce. A Yeti Tundra Haul cooler (color may vary), 2 Yeti 20oz Ramblers and to top it off a processed half-beef from Bishop Warfel's herd of cattle. Total Package Value of \$3000 each. *(processing of the beef will occur after the drawing)*

WINNERS

- All four Major Prize winners and four Early Bird cash prize winners will be decided through a random drawing of tickets received by the entry dates listed above.
- Early Bird cash winners will automatically be entered into the 4 major prize drawings.
- Early Bird cash prizes are limited to one cash prize per ticket.
- Major prizes are limited to one major prize per ticket.
- Winners must be U.S. residents of any age. Employees of the Chancery of the Diocese of Great Falls-Billings and their spouses are not eligible to win.
- Winners are responsible for paying all associated taxes, as required by law.
- Winners need not be present.
- Winners names will be listed on Diocese website shortly after each drawing.

MORE INFORMATION

Contact Diocese of Great Falls-Billings, 121 23rd Street South, Great Falls, Montana 59401, 406.727.6683, chancery@diocesegfb.org